

VHF system with handheld microphone

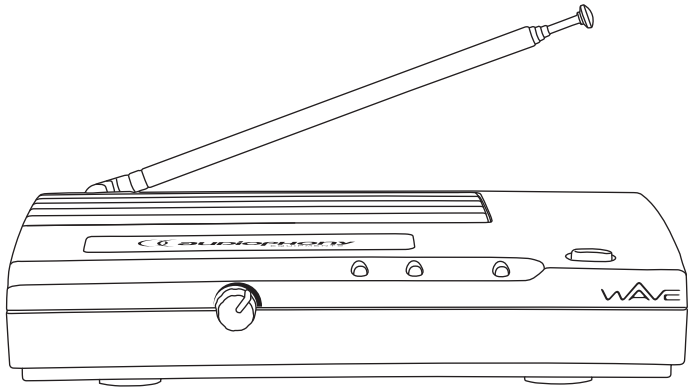

1 - Safety information

Important safety information

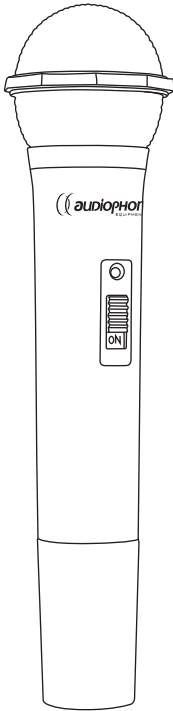

This unit is intended for indoor use only. Do not use it in a wet, or extremely cold/hot locations. Failure to follow these safety instructions could result in fire, electric shock, injury, or damage to this product or other property.



This product contains non-isolated electrical components. Do not undertake any maintenance operation when it is switched on as it may result in electric shock.



Any maintenance procedure must be performed by a CONTEST authorised technical service. Basic cleaning operations must thoroughly follow our safety instructions.



CAUTION
RISK OF ELECTRIC SHOCK
DO NOT OPEN



WARNING : This unit contains no user-serviceable parts. Do not open the housing or attempt any maintenance by yourself. In the unlikely even your unit may require service, please contact your nearest dealer. In order to avoid any electrical malfunction, please do not use any multi-socket, power cord extension or connecting system without making sure they are perfectly isolated and present no defect.



Risk of electrocution

To prevent the hazard of electric shocks, do not use extension cords, multi-socket or any other connection system without making sure metal parts completely are out of reach.



Sound levels

Our audio solutions deliver important sound pressure levels (SPL) that can be harmful to human health when exposed during long periods. Please do not stay in close proximity of operating speakers.



Recycling your device

- As HITMUSIC is really involved in the environmental cause, we only commercialise clean, ROHS compliant products.
- When this product reaches its end of life, take it to a collection point designated by local authorities. The separate collection and recycling of your product at the time of disposal will help conserve natural resources and ensure that it is recycled in a manner that protects human health and the environment.

Symbols used



This symbol signals an important safety precaution.



The CAUTION symbol signals a risk of product deterioration.



The WARNING symbol signals a risk to the user's physical integrity. The product may also be damaged.

Instructions and recommendations

1 - Please read carefully :

We strongly recommend to read carefully and understand the safety instructions before attempting to operate this unit.

2 - Please keep this manual :

We strongly recommend to keep this manual with the unit for future reference.

3 - Operate carefully this product :

We strongly recommend to take into consideration every safety instruction.

4 - Follow the instructions:

Please carefully follow each safety instruction to avoid any physical harm or property damage.

5 - Avoid water and wet locations :

Do not use this product in rain, or near washbasins or other wet locations.

6 - Installation :



We strongly encourage you to only use a fixation system or support recommended by the manufacturer or supplied with this product. Carefully follow the installation instructions and use the adequate tools.

Always ensure this unit is firmly fixed to avoid vibration and slipping while operating as it may result in physical injury.

7 - Ceiling or wall installation :

Please contact your local dealer before attempting any ceiling or wall installation.

8 - Ventilation :



The cooling vents ensure a safe use of this product, and avoid any overheating risk.

Do not obstruct or cover these vents as it may result in overheating and potential physical injury or product damage. This product should never be operated in a closed non-ventilated area such as a flight case or a rack, unless cooling vents are provided for the purpose .

9 - Heat exposure :

Sustained contact or proximity with warm surfaces may cause overheating and product damages. Please keep this product away from any heat source such as a heaters, amplifiers, hot plates, etc...

10 - Electric power supply :



This product can only be operated according to a very specific voltage. These information are specified on the label located at the rear of the product.

11 - Power cords protection:



Power-supply cords should be routed so that they are not likely to be walked on or pinched by items placed upon or against them, paying particular attention to cords at lugs, convenience receptacles and the point where they exit from the fixture.

12 - Cleaning precautions :



Unplug the product before attempting any cleaning operation. This product should be cleaned only with accessories recommended by the manufacturer. Use a damp cloth to clean the surface. Do not wash this product.

13 - Long periods of non use :

Disconnect the unit's main power during long periods of non use.

14 - Liquids or objects penetration :



Do not let any object penetrate this product as it may result in electric shock or fire.

Never spill any liquid on this product as it may infiltrate the electronic components and result in electric shock or fire.

15 - This product should be serviced when :



Please contact the qualified service personnel if :

- The power cord or the plug has been damaged.
- Objects have fallen or liquid has been spilled into the appliance.
- The appliance has been exposed to rain or water.
- The product does not appear to operate normally.
- The product has been damaged.

16 - Inspection/maintenance :



Please do not attempt any inspection or maintenance by yourself. Refer all servicing to qualified personnel.

17 - Operating environment :



Ambient temperature and humidity: +5 - +35°C, relative humidity must be less than 85% (when cooling vents are not obstructed).

Do not operate this product in a non-ventilated, very humid or warm place.

2 - Introduction

Thank you for purchasing the WAVE VHF system.

You are now in possession of a high-performance VHF microphone which will meet your every need for speeches, animations, etc.

The user guide you are currently reading will help you get familiar with the many functions and possibilities of your new device.

Please keep it within reach during the first few uses.

3 - Description

3.1 - Technical specifications

Your wave features two frequencies, allowing you to use two systems simultaneously.

- Receiver:
 - Three LEDs indicate the ON/OFF status, reception quality and signal detection
 - Adjustable output volume to avoid signal saturations
 - Unbalanced Jack 6.35 output (jack/jack cable supplied)
 - Power supply via AC adapter (supplied): 9V DC 300mA

- Microphone:
 - Cardioid dynamic microphone
 - ABS housing and steel mesh grille
 - OFF/Mute/ON Switch
 - Pop filter
 - Frequency response: 40 to 13K HZ
 - Signal-to-noise ratio: 80 dB
 - Range: Up to 50 meters (with optimal conditions)
 - Operates with a 9 V battery (6LR-61)

3.2 - Package contents

Please check the package contents upon reception of your WAVE. If one or several articles were to be missing, please contact your retailer immediately.

The package must contain the following articles:

- A receiver
- A handheld microphone
- An AC adapter
- A Mono Jack/Jack 6.35 cable
- The user guide



The VHF WAVE series features two frequencies: 177.5 and 185.3 MHz.

Please make sure both the receiver and transmitter are using the same frequency.

If they were not, call your retailer.

3.2 - Description

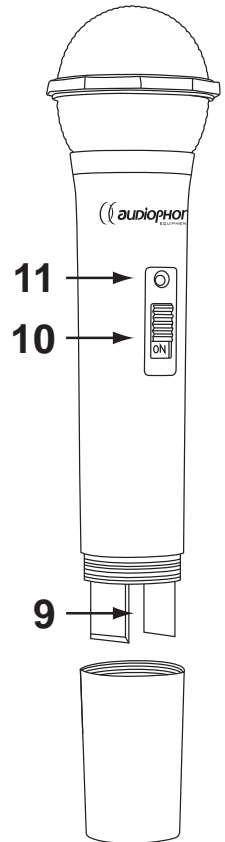
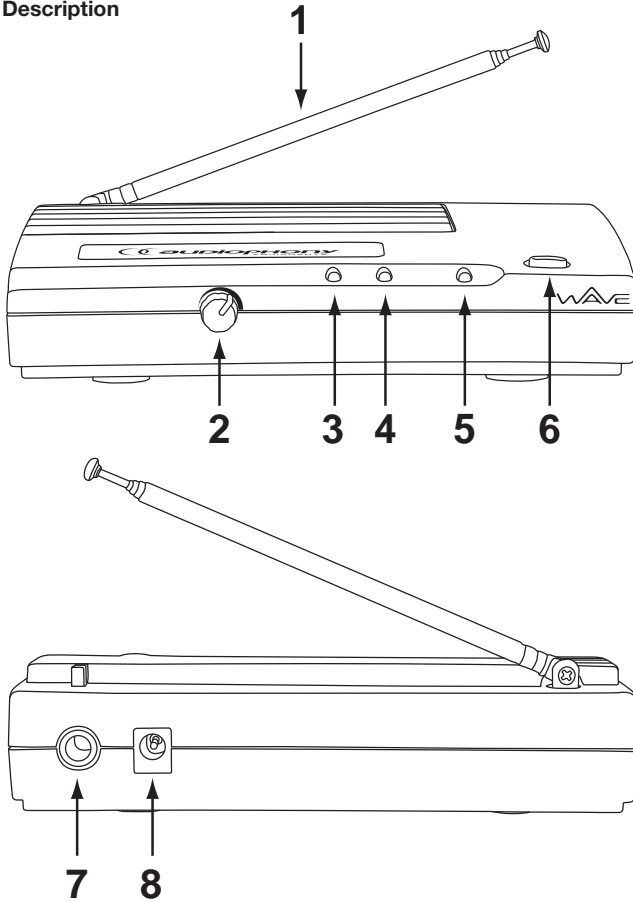

1 - Antenna

Deploy this antenna to guarantee the best reception possible.

2 - Volume control knob

Use this knob so the signal will not be saturated by the amplifier or mixing desk to which the receiver is connected.

3 - Red LED

Lights up when the receiver is activated but not receiving any signal.

4 - Green LED

Lights up when the receiver detects an incoming signal from the microphone.

5 - Power LED

Lights up when the receiver is activated.

6 - POWER Button

Activates/deactivates the receiver.

7 - Audio output

Unbalanced mono Jack 6.35 line-level output.

8 - Power input socket

Connect here the supplied AC adapter.
CAUTION: 9V DC - 300mA.

9 - Battery compartment

6LR61 9V Battery

10 - Microphone switch

This switch features three positions:

- Off : (Low position) Microphone deactivated.
- On : (Top position) Microphone activated.
- Mute : (Middle position) The microphone is activated but its capsule is disconnected. This position allows you to maintain the signal between receiver and transmitter without audio output.

11 - Microphone LED

Briefly lights up upon microphone activation.
Continuously lights up when the battery runs low.

4 - Getting started

- 1 - Open the battery compartment by unscrewing counterclockwise the lower part of the microphone.
- 2 - Insert a 9 V battery, making sure to respect the polarities.
- 3 - Close the battery compartment. It is crucial to screw this compartment tightly as it is a contact surface for the battery electrodes.
- 4 - Activate your receiver by pressing the Power button.
- 5 - If need be, adjust the output via the volume control knob on the front panel.
- 6 - Put the power switch onto the top position, the indicator will flash to indicate the microphone is now activated.
- 7 - Use the middle position to mute the microphone when you do not need to talk.
- 8 - Use the "OFF" position when the microphone is not needed. Please remove the battery during long periods of non-use in order to prevent leaks and damage your device.
- 9 - The LED indicator should not be lit once the microphone is activated. Remaining lit up indicates the battery levels are too low. The battery is incorrectly inserted or fully empty if the indicator does not light up at all.

5 - Troubleshooting

It is crucial to take some time to read this user guide before using your microphone in order to prevent poor handling which may cause severe damage to your device.

- > Please make sure the mains deliver 230V before connecting your system.
- > If the indicator of your microphone is continuously lit, that indicates the battery must be replaced by an identical one. Please respect the polarities.
- > When signal alterations appear, please check the distance between the transmitter and receiver, and check the battery. Adjust the antenna or replace the battery if need be.
- > Do not drop your microphone, do not hit the grille or blow too hard into the microphone.



Beware feedbacks
Do not allow excessive sound levels.
Please keep a safe distance between the audience and the speakers.
Feedbacks can cause severe damages to your system and your hearing.



6 - Circuit principle

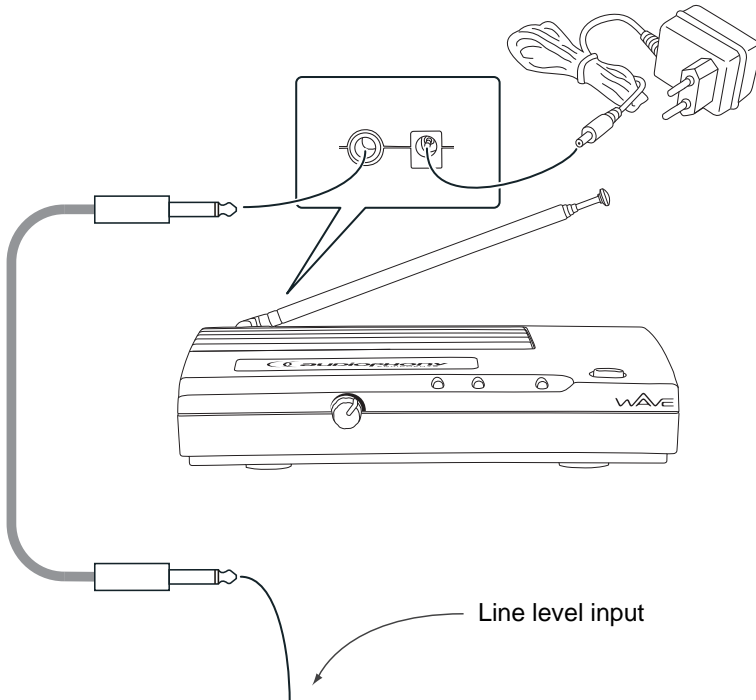

Line level input

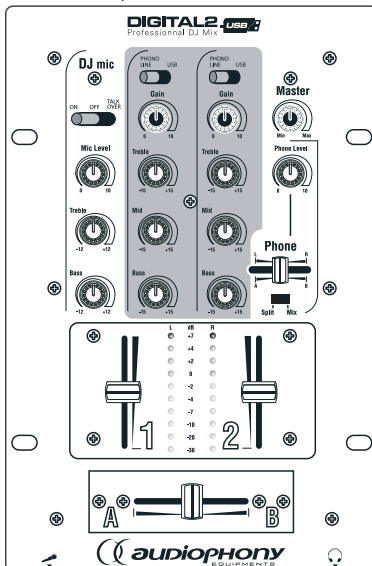

Mixer

Note:

This example describes a installation with your receiver connected to a mixing desk. Your receiver can, of course, be connected directly to an amplifier. In order to guarantee the best audio quality, please use a line-level input to connect the receiver (0,775V).

Because AUDIOPHONY® takes the utmost care in its products to make sure you only get the best possible quality, our products are subjects to modifications without prior notice. That is why technical specifications and the products physical configuration might differ from the illustrations.

Make sure you get the latest news and updates about the AUDIOPHONY® products on www.audiophony.com
AUDIOPHONY® is a trademark of HITMUSIC S.A. - Zone Cahors sud - 46230 FONTANES - FRANCE